

08/10/17 G:\Projects\T-16628 SH 74 @ NW 178th, NW 92nd & NW 206th\CAD\TC PHASE 30P0RST-5 SH 74.dgn

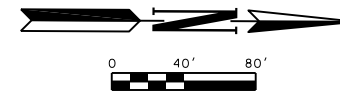

| REVISIONS | | |
|-----------|-------------|------|
| NO. | DESCRIPTION | DATE |
| | | |

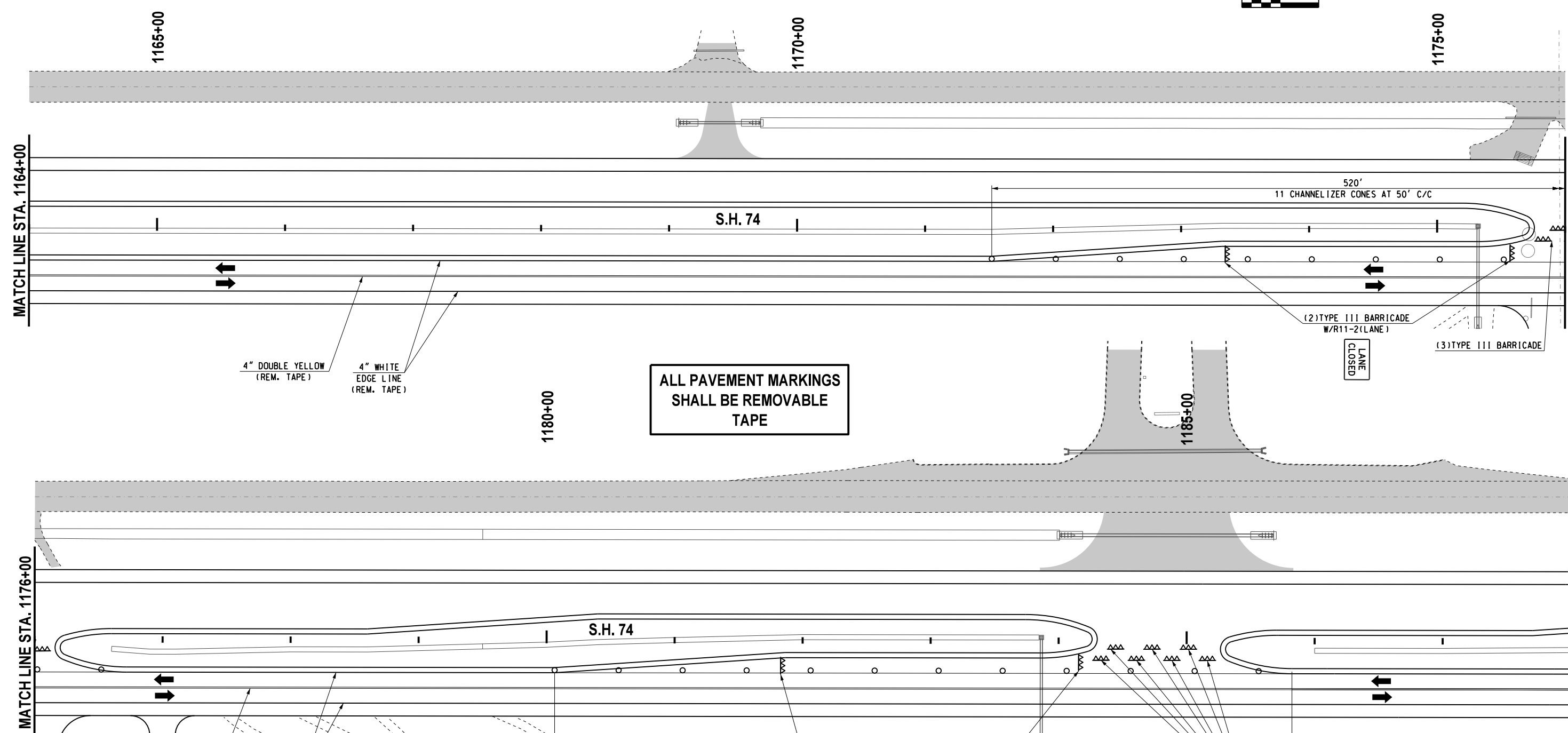

4" DOUBLE YELLOW
(REM. TAPE)

4" WHITE
EDGE LINE
(REM. TAPE)

ALL PAVEMENT MARKINGS
SHALL BE REMOVABLE
TAPE

(2) TYPE III BARRICADE
W/R11-2(LANE)

LANE
CLOSED

(3) TYPE III BARRICADE

4" DOUBLE YELLOW
(REM. TAPE)

4" WHITE
EDGE LINE
(REM. TAPE)

575'
12 CHANNELIZER CONES AT 50' C/C

(2) TYPE III BARRICADE
W/R11-2(LANE)

LANE
CLOSED

(7) TYPE III BARRICADE

CONTRACTOR SHALL KEEP
11' MINIMUM LANES UNLESS
OTHERWISE NOTED.

CONTRACTOR TO PROVIDE
ACCESS TO ALL DRIVEWAYS
DURING CONSTRUCTION.

| LEGEND | |
|--------|--|
| △△ | - TYPE III BARRICADE W/ TWO TYPE "A" LIGHTS |
| ● | - DRUM |
| ○ | - CHANNELIZER CONE |
| ▬ | - PORTABLE CONC. BARRIER WALL |
| ▬▬ | - CONSTRUCTION ZONE IMPACT ATTENUATOR |
| ■ | - WORK AREA |

| | | |
|--------|-----|----------|
| Design | RWR | 08/10/17 |
| Drawn | GDB | 08/10/17 |

TRAFFIC CONTROL
PHASES 30,P,Q,R,S & T (SHEET 5 OF 7)
S.H. 74 (STA. 1164+00 TO 1188+00)
 State Job No. 14964(08) Sheet No. T81